

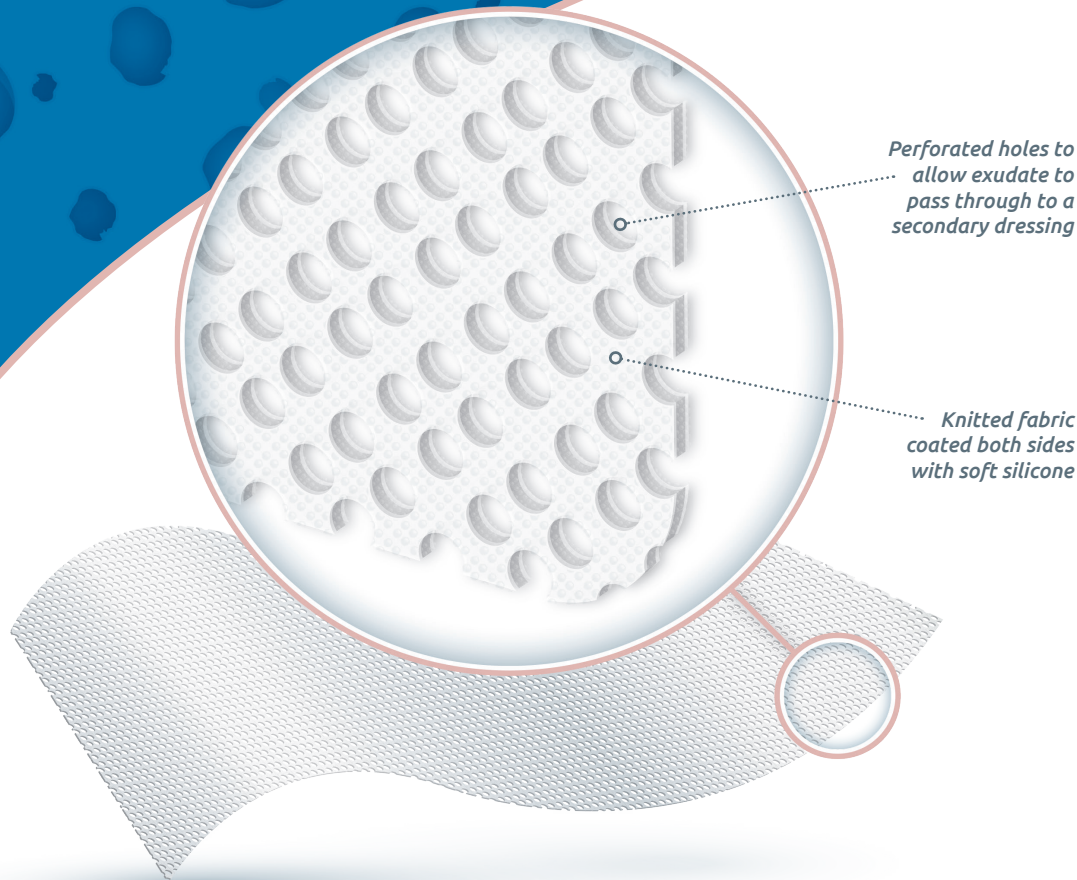

Silicone Wound Contact Layer (SWCL)



Advanced Medical Solutions Ltd



Prevents the dressing from sticking to the wound & minimises trauma

- ✓ **Soft silicone coating**
Protects the sensitive granulated wound bed.
- ✓ **Can remain in place for up to 14 days**
Allow cost effective and undisturbed wound healing. The secondary outer pad can be changed without damaging the primary silicone wound contact layer.
- ✓ **Perforated holes**
Allows exudate to pass through to secondary dressing.
- ✓ **Indicated to use in conjunction with negative pressure wound therapy**
Can be used on a variety of wounds.
- ✓ **Minimal epidermal stripping or pain on removal**
Secure adhesion.

Artist's impression

Silicone wound contact layer dressing is a primary dressing for use when adherence to the wound is a potential problem. Soft silicone wound contact layer is designed with an open mesh to allow exudate to pass through to the secondary dressing.

The silicone wound contact layer creates a layer between the dressing and the skin surface which allows the dressing to be removed without causing trauma, pain or damaging the delicate new tissue at the wound margin. On the skin, the dressing will provide secure adhesion with minimal epidermal stripping or pain on removal.

Indications

Nil to heavily exuding chronic and acute wounds (with appropriate secondary dressing).

The dressing can be used in conjunction with Negative Pressure Wound Therapy (NPWT).

The dressing maybe used throughout the healing process on:

- ▶ Skin tears
- ▶ Surgical incisions
- ▶ Partial thickness burns
- ▶ Pressure ulcers
- ▶ Partial thickness skin grafts
- ▶ Venous and arterial ulcers

Dressing Application

Cleanse the wound area according to appropriate wound care protocols. Dry the surrounding areas of the wound thoroughly before dressing application.

- 1. Select a size of Silicone Wound Contact Layer dressing making sure the dressing size is slightly larger than the wound. Remove one release liner from the wound dressing.**
- 2. Centre the dressing on the wound and apply it gently to the wound site. Press the dressing on the surrounding skin by gentle application of pressure. The second release liner can then be removed.**
- 3. Apply secondary absorbent dressing**

Contact

Advanced Medical Solutions Ltd
Premier Park
33 Road One
Winsford Industrial Estate
Winsford
Cheshire
CW7 3RT
UK

Tel: +44(0) 1606 863 500
Email: sales@admedsol.com

www.admedsol.com

Product selection



Product Selection	
<input type="checkbox"/> Sheet	
5cm x 7.5cm	2" x 3"
10cm x 10cm	4" x 4"
15cm x 15cm	6" x 6"
10cm x 20cm	4" x 8"

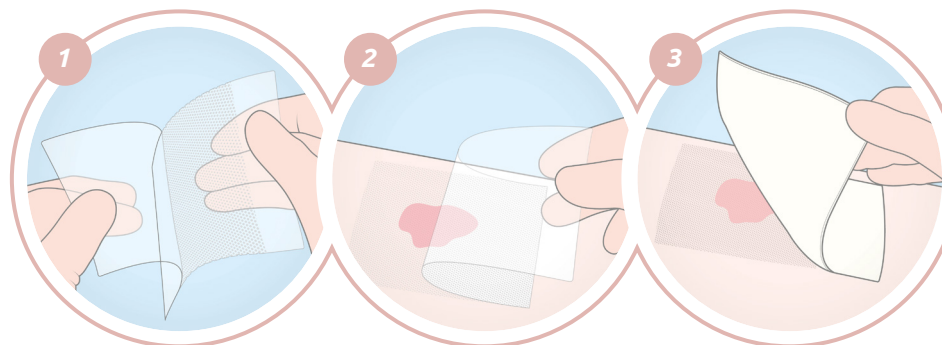

Helping you help others

Advanced Medical Solutions excels in both the research and development of foam dressings, through continuous product development and by working closely within the market place we meet the needs of the clinician, patient and our commercial partners.